

For Lease - Ready to go space!

±1,295-88,741 SF
Office Space Available
Lauderhill, Florida



Corporate Park at Inverrary
3800-3810 Inverrary Blvd.
Lauderhill, Florida 33319

Property Highlights

- Twin 4-story office buildings totaling ±118,120 SF
- Available suites range from 1,295 SF to 17,077 SF
- The entire 3800 building is available for a single user
- Inverrary Golf Course and water view available for every suite
- Convenient access to I-95 and the Florida Turnpike
- Property is located 3/4 of a mile north of Oakland Park Blvd. on the east side of Inverrary Blvd.
- Property offers 332 surface level parking spaces with current parking ratio of 3.0/1000. Additional parking ratio possible up to 5.0/1000.
- Generous tenant improvement allowances and ready to move in suites available.

Rental Rate:

\$11.50 Modified Gross

Rental Rate is net of electric and janitorial.
Tenant controls their own A/C.
Preferred lease terms of 3-5 years.

For more information:

Elizabeth Boudreau

954 489 2534
eboudreau@rwnk.com

Bill McConnell

954 489 4721
billmcconnell@rwnk.com

Kenneth L. Kurtz, CCIM

954 489 4704
kkurtz@rwnk.com

NO WARRANTY OR REPRESENTATION, EXPRESS OR IMPLIED, IS MADE AS TO THE ACCURACY OF THE INFORMATION CONTAINED HEREIN, AND THE SAME IS SUBMITTED SUBJECT TO ERRORS, OMISSIONS, CHANGE OF PRICE, RENTAL OR OTHER CONDITIONS, PRIOR SALE, LEASE OR FINANCING, OR WITHDRAWAL WITHOUT NOTICE, AND OF ANY SPECIAL LISTING CONDITIONS IMPOSED BY OUR PRINCIPALS NO WARRANTIES OR REPRESENTATIONS ARE MADE AS TO THE CONDITION OF THE PROPERTY OR ANY HAZARDS CONTAINED THEREIN ARE ANY TO BE IMPLIED.

5300 North Federal Highway
Fort Lauderdale, Florida 33308
954 771 4400

rwnk.com rwnkblog.com

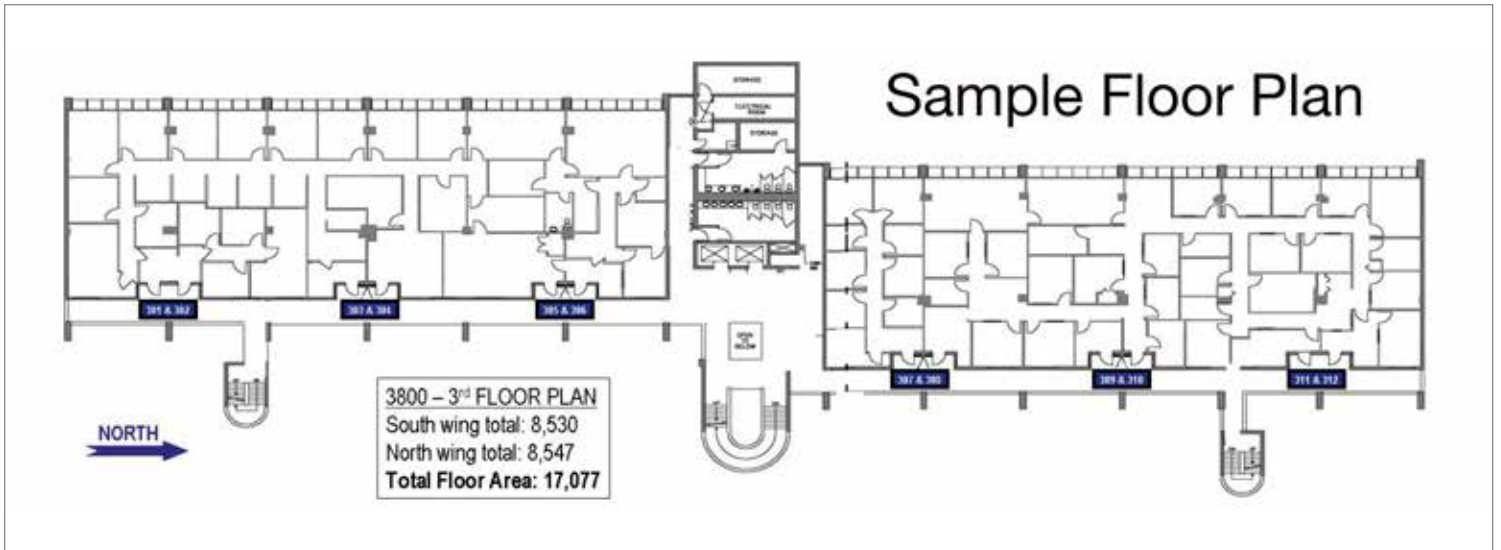

Corporate Park at Inverrary
3800-3810 Inverrary Blvd.
Lauderhill, Florida 33319

For more information:

Elizabeth Boudreau

954 489 2534

eboudreau@rwnk.com

Bill McConnell

954 489 4721

billmcconnell@rwnk.com

Kenneth L. Kurtz, CCIM

954 489 4704

kkurtz@rwnk.com